

# ADJUSTABLE PANEL DOLLY - PLDL-ADJ-10FF

APPROX WEIGHT: 42.91 lbs.  
 DOES NOT INCLUDE WEIGHT OF POWER OR PACKAGING!!!

\*\*\*ANY ADDITIONS, DELETIONS, OR OMISSIONS MUST BE CORRECTED ON THIS DRAWING AS THIS DRAWING WILL BE CONSIDERED ALL INCLUSIVE\*\*\*

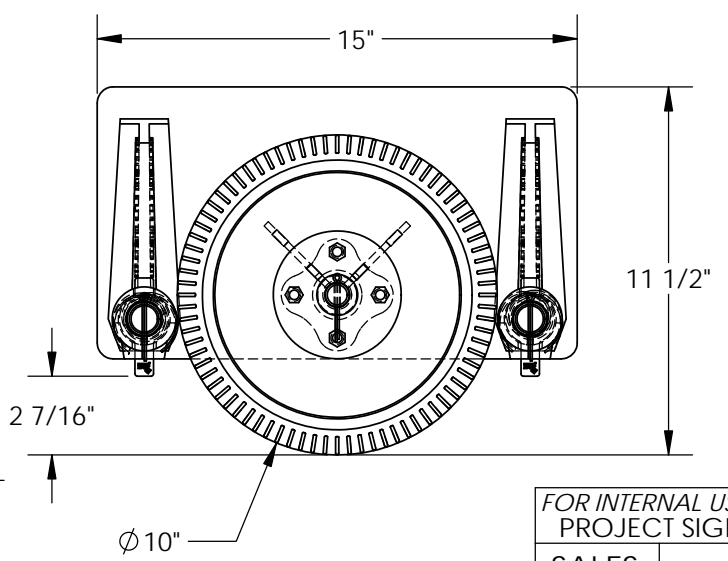
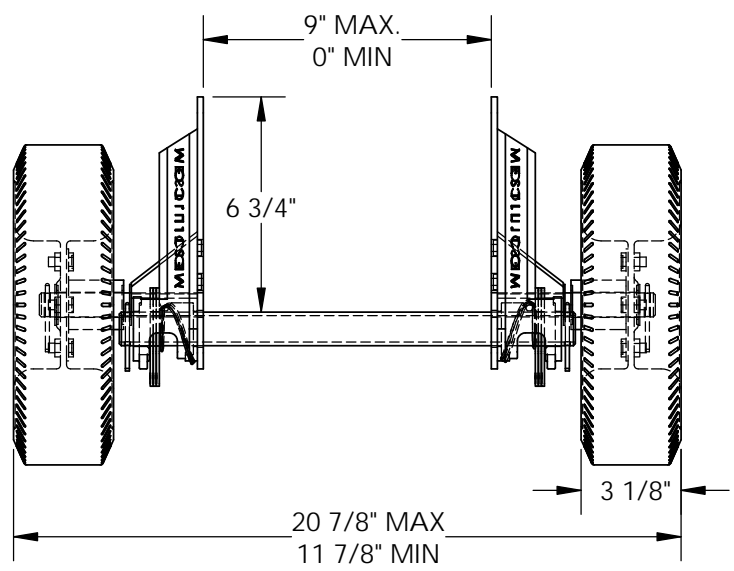
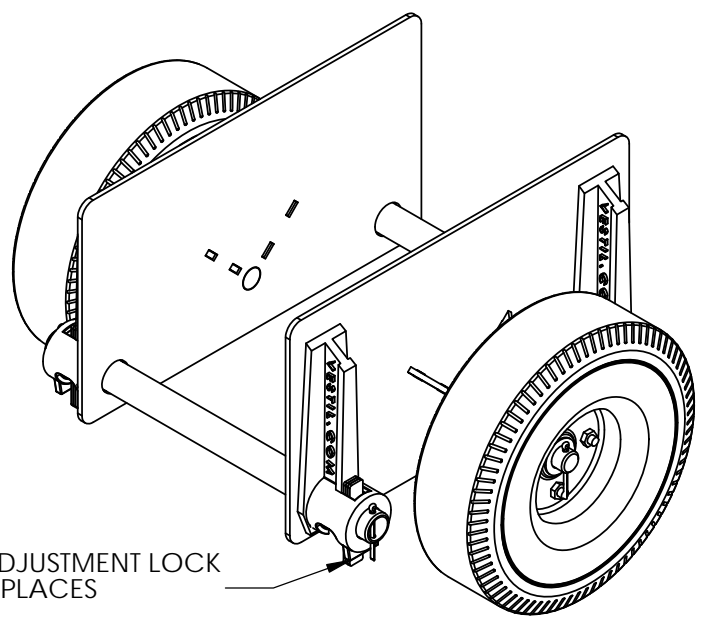
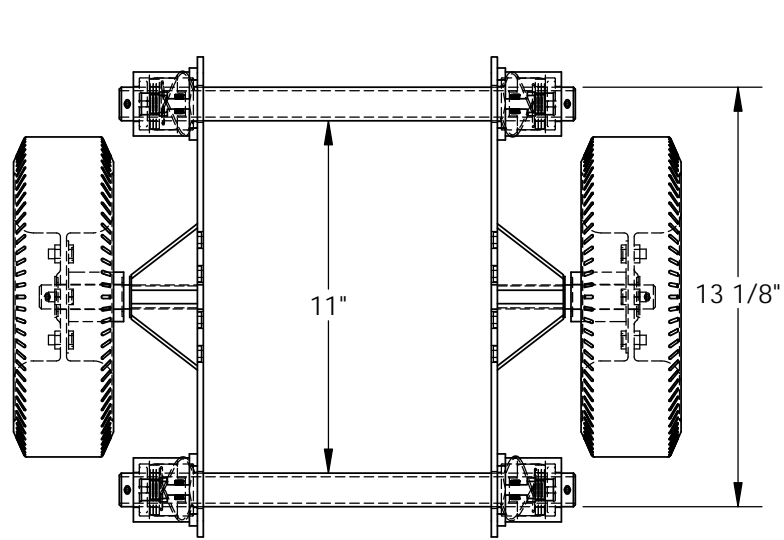

|                       |  |
|-----------------------|--|
| FOR INTERNAL USE ONLY |  |
| PROJECT SIGN OFF      |  |
| SALES                 |  |
| ENG.                  |  |
| FAB.                  |  |
| POWER                 |  |

ALL GRAPHICS PROVIDED ARE FOR REFERENCE ONLY. IF CERTAIN DIMENSIONS ARE CRITICAL PLEASE VERIFY THOSE DIMENSIONS WITH YOUR SALESPERSON

DIMENSION TOLERANCE ± 1/4"

## STANDARD FEATURES

- MODEL NUMBER IS PLDL-ADJ-10FF
- CAPACITY IS: 500 LBS.
- OVERALL LENGTH IS: 15"
- OVERALL HEIGHT IS: 11 1/2"
- MAX. OVERALL WIDTH IS 20 7/8"
- MIN. OVERALL WIDTH IS 11 7/8"
- POSITIVE LOCKING CLUTCH PLATES ALLOW FOR EASIER RELEASE AND ADJUSTMENT
- DOLLY OPENING RANGE IS 0" - 9"
- STEEL CONSTRUCTION WITH TOUGH BAKED IN POWDERCOATED YELLOW FINISH
- (2) Ø10" x 3 1/8" FOAM-FILLED WHEELS

## SPECIAL FEATURES

NONE

|                                                              |                                                                                                                                                                                                                                                          |             |
|--------------------------------------------------------------|----------------------------------------------------------------------------------------------------------------------------------------------------------------------------------------------------------------------------------------------------------|-------------|
| <b>APPROVAL</b>                                              | I, THE UNDERSIGNED, AGREE THAT THE PRODUCT AS REPRESENTED SATISFIES DESIGN AND DIMENSION REQUIREMENTS. I ALSO ACKNOWLEDGE MY DUTY TO CONFIRM PRODUCT AND INSTALLATION COMPLIANCE WITH ALL APPLICABLE FEDERAL, STATE AND LOCAL REGULATIONS AND STANDARDS. |             |
|                                                              | <b>ANY MODIFIED UNITS ARE NON-RETURNABLE</b>                                                                                                                                                                                                             |             |
|                                                              | [ ] As drawn [ ] As marked                                                                                                                                                                                                                               |             |
|                                                              | Signed: _____                                                                                                                                                                                                                                            | Date: _____ |
| Printed Name: _____                                          |                                                                                                                                                                                                                                                          |             |
| LEAD TIME WILL START UPON RECEIPT OF SIGNED APPROVAL DRAWING |                                                                                                                                                                                                                                                          |             |

|                      |            |            |
|----------------------|------------|------------|
| DISTRIBUTOR'S NAME:  |            | P.O.#      |
| VESTIL MANUFACTURING |            | X          |
| DRAWN BY: TJM        |            | W.O.#      |
| DATE: 03/19/2012     |            | X          |
| REFERENCE: X         | SCALE: 1:6 | SALES: X   |
| QUOTED LEAD TIME: X  | QUOTE # X  | FILE NAME: |
|                      |            | 16-007-316 |